

- > 14.7 Foot Long
- > Internal Shower and Toilet
- > Internal and External Kitchen
- > Roof Mounted Winch
Operated Boat Loader
- > All-round Rock Sliders
- > Airbag Suspension

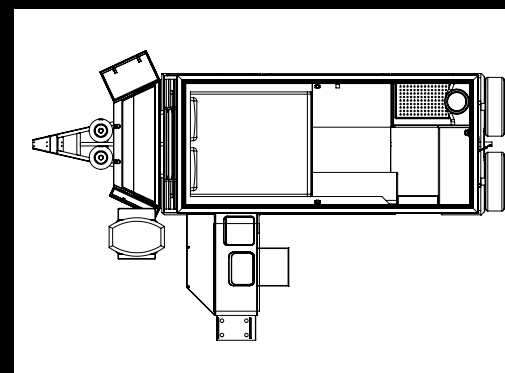

- ✦ 150x50x3mm Galvanized steel chassis, welded together, zinc primed and powder coated Ripple Black
- ✦ Full internal and external kitchen
- ✦ Inside 121 litre fridge
- ✦ Internal shower and toilet facilities
- ✦ External shower
- ✦ Specially designed toolbox to carry generator, BBQ and even firewood

- ✦ Marine Grade solar panels - twin 180 watt
- ✦ Bluetooth Radio/CD/USB/SD/TV remote controlled stereo with external LED speakers
- ✦ Airtronic diesel heater
- ✦ Internal air conditioner
- ✦ Twin 125 litre water tanks
- ✦ Custom made 35 litre stainless steel tank, fully filtered for drinking water

CHASSIS

- 150x50x3mm Galvanized steel, welded together, zinc primed and powder coated in Ripple Black
- Fitted with Dual independent airbag suspension
- 16 inch alloys with 32 inch mud terrain tyres giving the ultimate grip
- Fully articulated Do35 off road tow coupling rated for 3,500kg
- Extra strong heavy duty chassis raised for extra clearance assisting with your departure and approach angles
- 2 x rear wheel carry frame
- Heavy duty stabilizer legs to each corner
- 50mm diameter x 3mm wall thickness all-round rock sliders

GAS & ELECTRICAL

- Marine grade solar panels - twin 180 watt, producing the highest wattage output of any solar panel on the market
- 2 x 120amp RITA sealed deep cycle batteries
- Xantrex 40amp Battery Charger
- MPPT Solar Charger and Controller
- External working lights all four sides
- Signwave Inverter
- External charging station - USB, cigarette lighter, anderson plug and 240 volt points

PLUMBING

- Twin 125 litre water tanks with a custom made 35 litre stainless steel tank, fully filtered for drinking water
- Mains water pressure entry
- External pressure fed water fillers - LED water tank gauges

DIMENSIONS

Tare	2100 kg
ATM	3400 kg
Height	2600 mm
Width	2020 mm
Body Length	4500 mm
Total Length	6920 mm

INTERNAL

- Air-conditioning system
- 22.6 litre Suburban hot water unit
- Internal shower and toilet facilities
- Full internal kitchen - featuring two burner cooker and sink
- Dometic 121 litre 3 way fridge
- Queen size bed with inner spring mattress including 4 tie down points beside the bed with extra bedside storage
- 2 person seating plus table
- 'Fantastic' roof vent 3 speed over bed
- Large tinted double glazed windows, integrated fly screens and privacy screens
- Airtronic internal diesel heater

EXTERNAL

- Full aluminium powder coated black kitchenette - housing sink and 2 burner cook-top both with glass lids for additional bench space and an extra foldout benchtop. An added bonus is the marine grade pullout 2 burner barbecue for your early departures when on the road
- External shower
- 13 foot 'Granite Splash' Dometic roll out awning
- External 2 x 6 inch 200 watt 2-way waterproof LED speakers
- External main control box including charging station, TV mounting bracket and 10 amp power socket

STORAGE

- Front tunnel storage 600x500x1900mm with internal light
- Front storage locker with optional pull out barbecue and generator slide with opening top lid and extra storage and lighting. Fully lockable with timber storage on top for your National Park stays
- Full extension deep storage drawer above external kitchen and 2 drawer storage next to kitchen
- Internal overhead storage above bed and an additional twin drawer storage under bed
- Internal kitchenette storage area

EXTRAS

- Bluetooth Radio/CD/USB/SD/TV remote controlled stereo with external LED speakers
- Roof mounted fully mechanical, winch operated boat lowering system
- 12 volt powered rams for electronic lifting of the roof